

- maximum free fall height: 100 cm
- recommended ground surface:
minimum sub-soil, better: grass

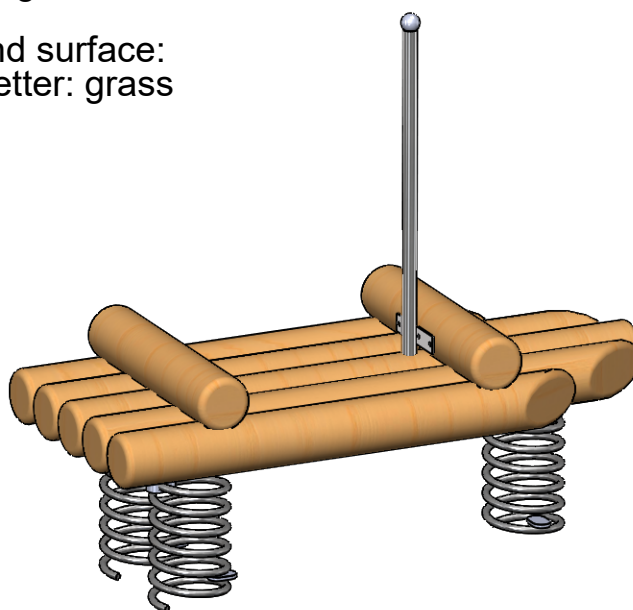

ASSEMBLY DRAWING

Bearbeiter: Hector Roca

Datum: 29.04.2020

Page: 1/2

Spiel-Bau GmbH
Alte Weinberge 21 - D-14776 Brandenburg / Havel
Tel.: 03381 / 26 14 0 - Fax.: 03381 / 26 14 18

Spielfloß
Order-No.: 6.5530-F-en

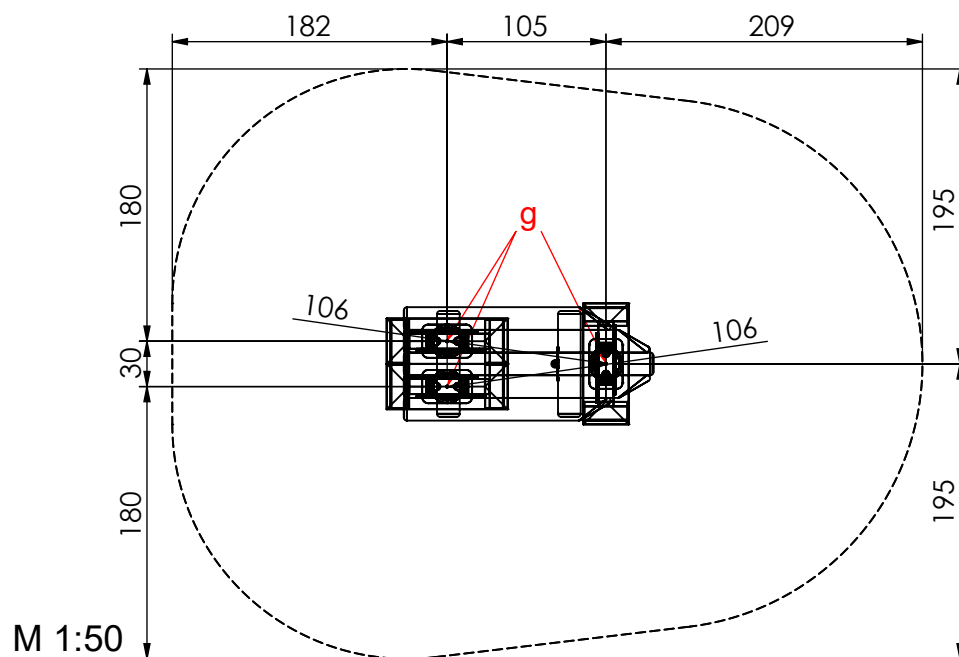

Foundation: In-situ concrete C25/30

- 3x Spring:
each 80x40x30 cm check detail g)

Assembly detail spring g)

M 1:25

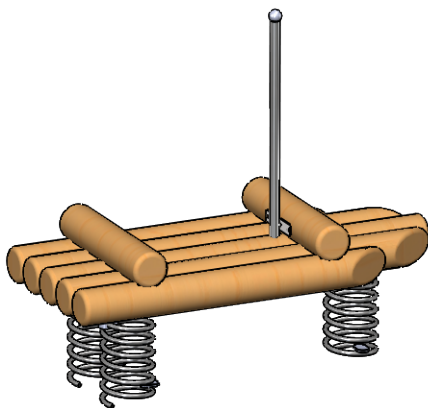
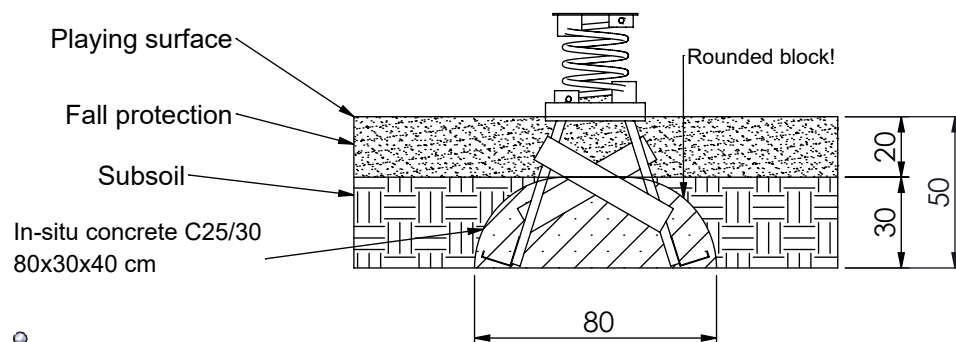

ASSEMBLY DRAWING

Bearbeiter: Hector Roca

Datum: 29.04.2020

Page: 2/2

Spiel-Bau GmbH
Alte Weinberge 21 - D-14776 Brandenburg / Havel
Tel.: 03381 / 26 14 0 - Fax.: 03381 / 26 14 18

Spielfloß
Order-No.: 6.5530-F-en